

# JSC-U 20mm CAVITY BATTEN SETOUT FOR HORIZONTAL WEATHERBOARD CLADDING

## LEGEND

- 1
- BOTTOM PLATE DETAIL
- 2
- CAVITY BATTEN - NON STRUCTURAL :  
JSC-U 45mm x 20mm Radiata Pine H3.2  
treated, both face castellated and 18°  
bevelled edges.
- 3
- WINDOW / DOOR DETAILS
- 4
- EXTERNAL CORNER DETAIL
- 5
- INTERNAL CORNER DETAIL
- 6
- TIMBER FRAMING : H1.2 min treated timber  
framing. Studs @600mm max. centres and  
nogs @800mm max. centres

For specific details 1 (Bottom Plate), 3 (Window/Door), 4 (External Corner), and 5 (Internal Corner), refer to the relevant detail set for the selected JSC Cladding System:  
[Technical Downloads](#)

## DETAIL NOTES

- Framing must be fit for purpose
- Cavity battens are profiled to JSC Timber specifications and treated to H3.2 CCA as per NZS 3640:2011
- Wall underlay and other building elements are not shown to provide clarity
- For comprehensive system detailing refer to the technical literature for your chosen JSC Cladding System.
- Visit [www.jsc.co.nz](http://www.jsc.co.nz) for most up to date information.

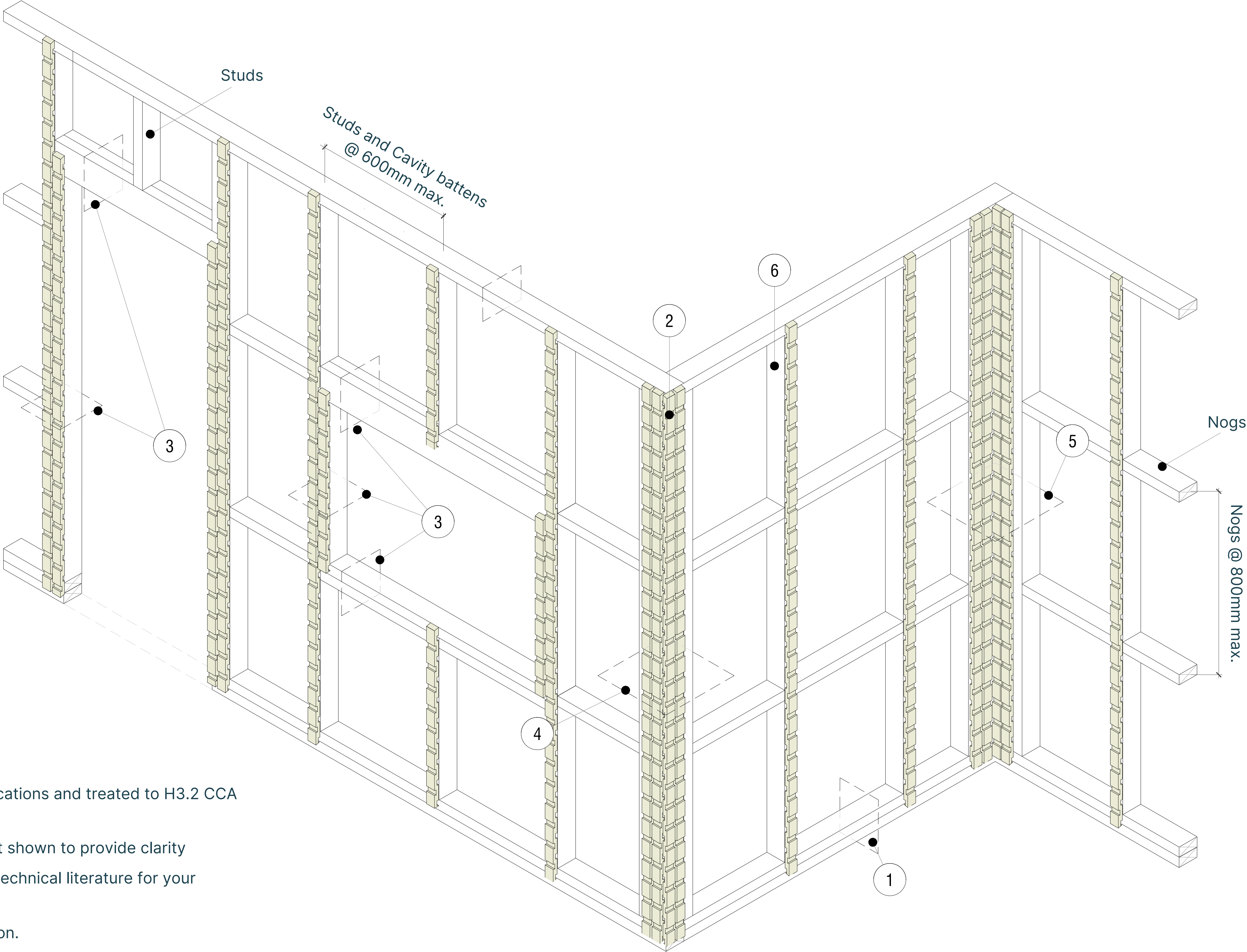

**DISCLAIMER:** THIS DETAIL IS DRAFTED FOR ILLUSTRATION PURPOSE ONLY. ACTUAL SETOUT MAY VARY TO SUIT DESIGN REQUIREMENTS.  
APPROPRIATE EXPERT ADVICE SHOULD ALWAYS BE OBTAINED TO ENSURE SUITABILITY OF THESE DRAWINGS FOR YOUR SPECIFIC APPLICATION.

**CodeMark**  
CERTIFIED

## NOTES

1. Cavity battens are profiled to JSC Specifications and are treated to H3.2 CCA as per NZS 3604:2011
2. Wall Underlay and other building components are not shown to provide more clarity
3. Rigid wall underlay to be fibre cement or plywood. Low density boards to be addressed appropriately
4. Details may be subject to change without notice
5. Framing must be as per NZS 3604:2011 or fit for purpose and other building elements may need to be accommodated
6. To be read in conjunction with complete JSC Cladding System literature. Visit [www.jsc.co.nz](http://www.jsc.co.nz)

SCAN IT FOR  
MORE  
INFORMATION



CAVITY BATTENS SETOUT  
JSC-U 45X20mm CAVITY BATTENS  
HORIZONTAL CLADDING

VERSION  
2.5  
DATE  
Sept-25  
SCALE  
1:4 & 1:10