

# JSC-U 20mm CAVITY BATTEN SETOUT FOR VERTICAL WEATHERBOARD CLADDING

**LEGEND**

- BPD BOTTOM PLATE DETAIL
- CB1 CAVITY BATTEN - NON STRUCTURAL :  
JSC-U 45mm x 20mm Radiata Pine  
H3.2 treated, both face castellated and  
18° bevelled edges.
- DD DOOR DETAILS
- ECD EXTERNAL CORNER DETAIL
- ICD INTERNAL CORNER DETAIL
- TF TIMBER FRAMING : H1.2 min treated  
timber framing. Studs @600mm centres  
max. and noggs @480mm centres max.
- TPD TOP PLATE DETAIL
- WD WINDOW DETAILS

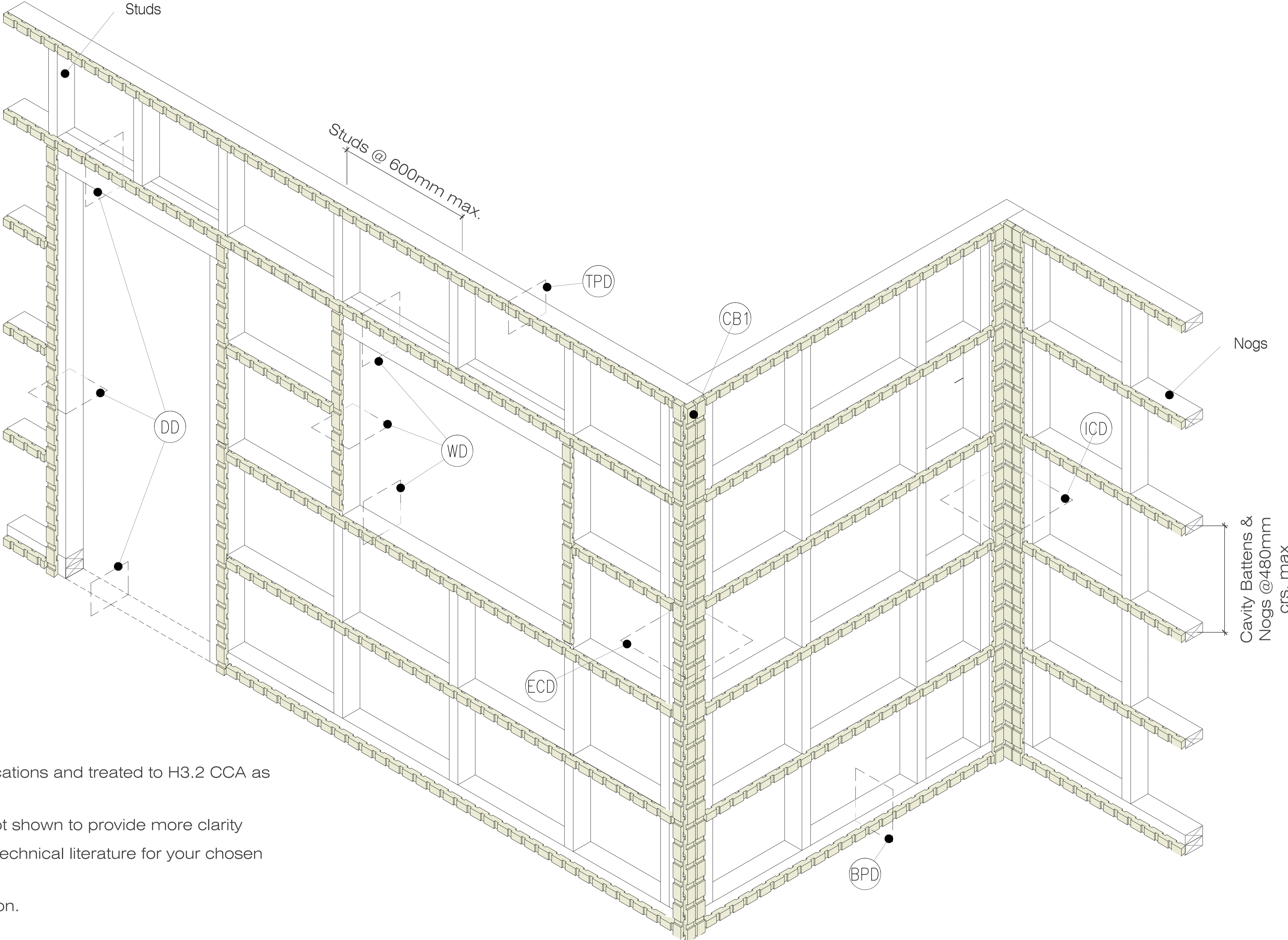

**DETAIL NOTES**

- Framing must be fit for purpose
- Cavity battens are profiled to JSC Timber specifications and treated to H3.2 CCA as per NZS 3640
- Wall underlay and other building elements are not shown to provide more clarity
- For comprehensive system detailing refer to the technical literature for your chosen JSC Cladding System.
- Visit [www.jsc.co.nz](http://www.jsc.co.nz) for most up to date information.

DISCLAIMER: THIS DETAIL IS DRAFTED FOR ILLUSTRATION PURPOSE ONLY. ACTUAL SETOUT MAY VARY TO SUIT DESIGN REQUIREMENTS.  
APPROPRIATE EXPERT ADVICE SHOULD ALWAYS BE OBTAINED TO ENSURE SUITABILITY OF THESE DRAWINGS FOR YOUR SPECIFIC APPLICATION.