

STRUCTURAL CAVITY BATTENS FIXING GUIDE

HORIZONTAL CAVITY BATTENS/ VERTICAL WEATHERBOARDS

H1 SCENARIO
JSC-H 45x45mm CAVITY BATTEN

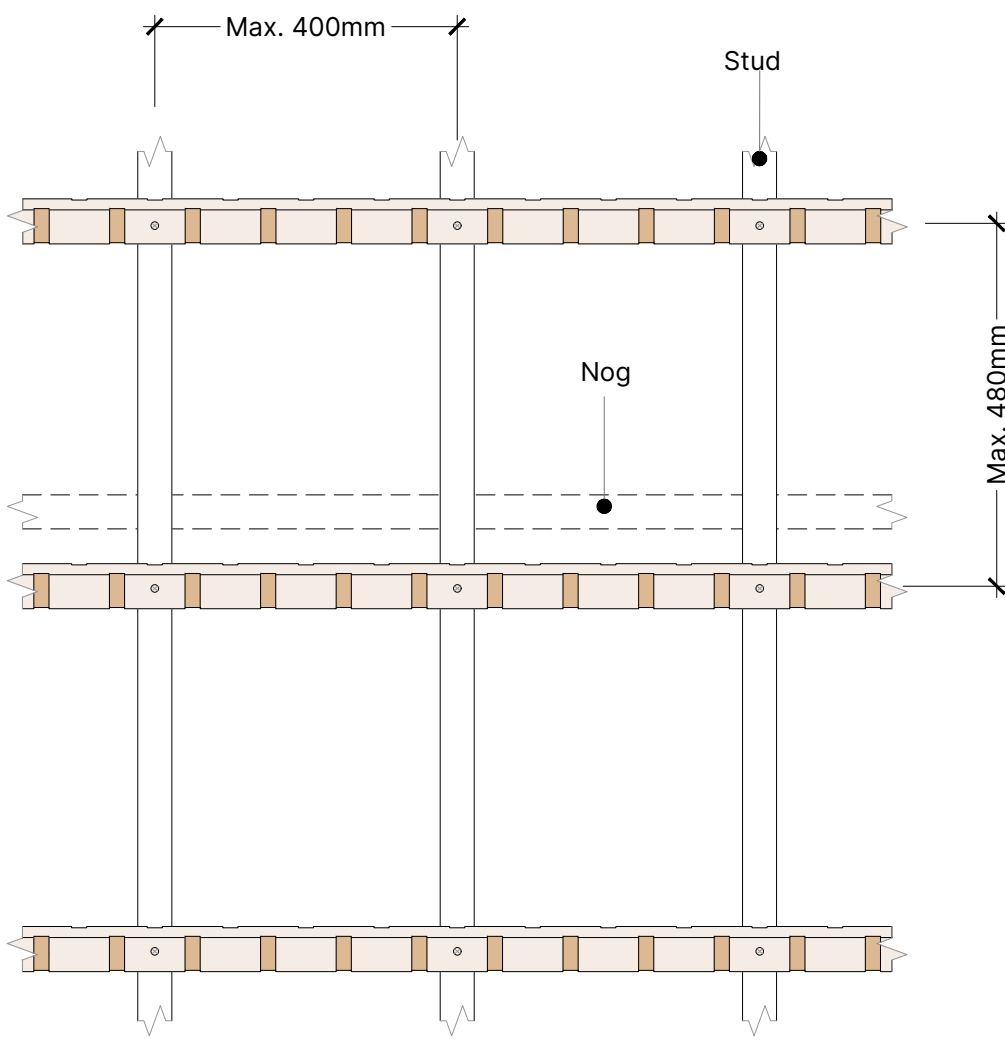

Studs @ 400mm | CB @ 480mm max.

In this scenario Cavity Battens are not required to be supported by a nog

H2 SCENARIO
JSC-H 45x45mm CAVITY BATTEN

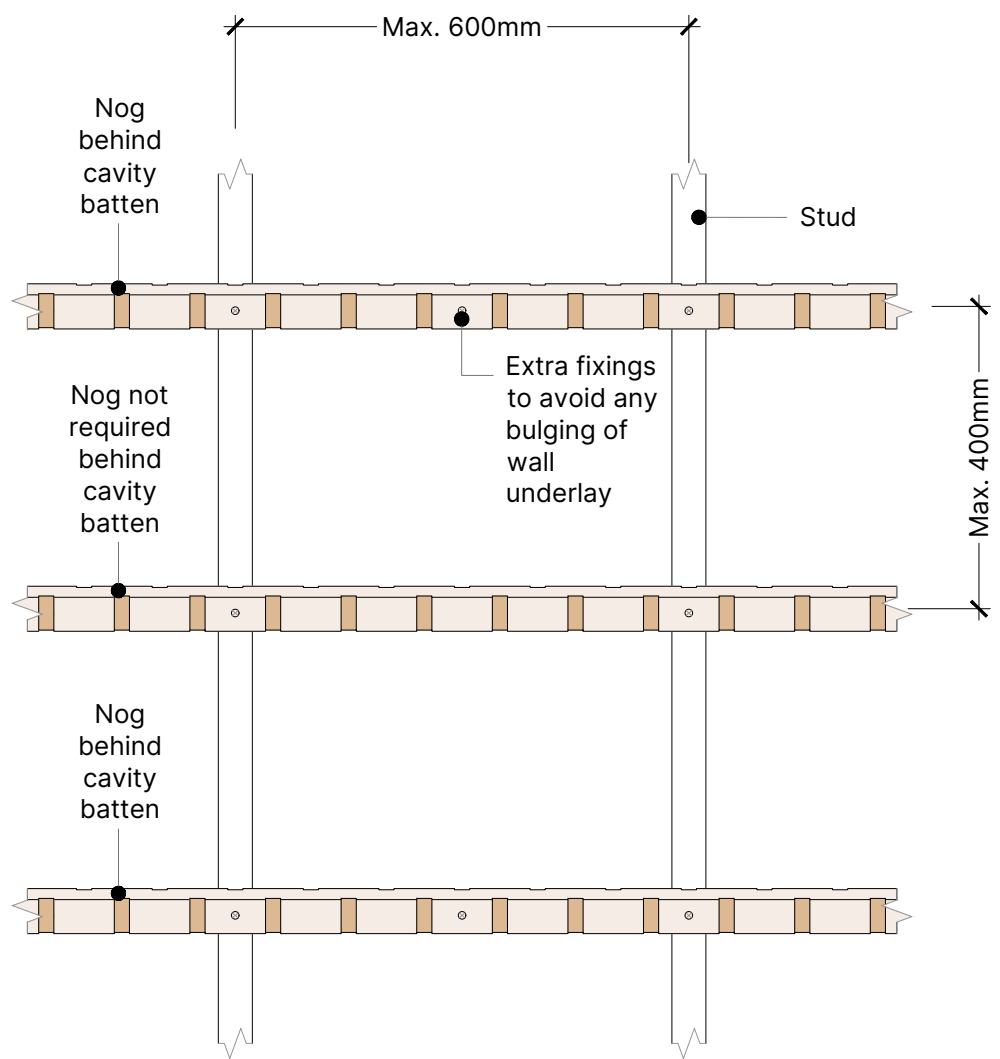

Studs @ 600mm | CB @ 400mm max.

Alternating nogs behind every second cavity batten

H3 SCENARIO
JSC 70x45mm CAVITY BATTEN

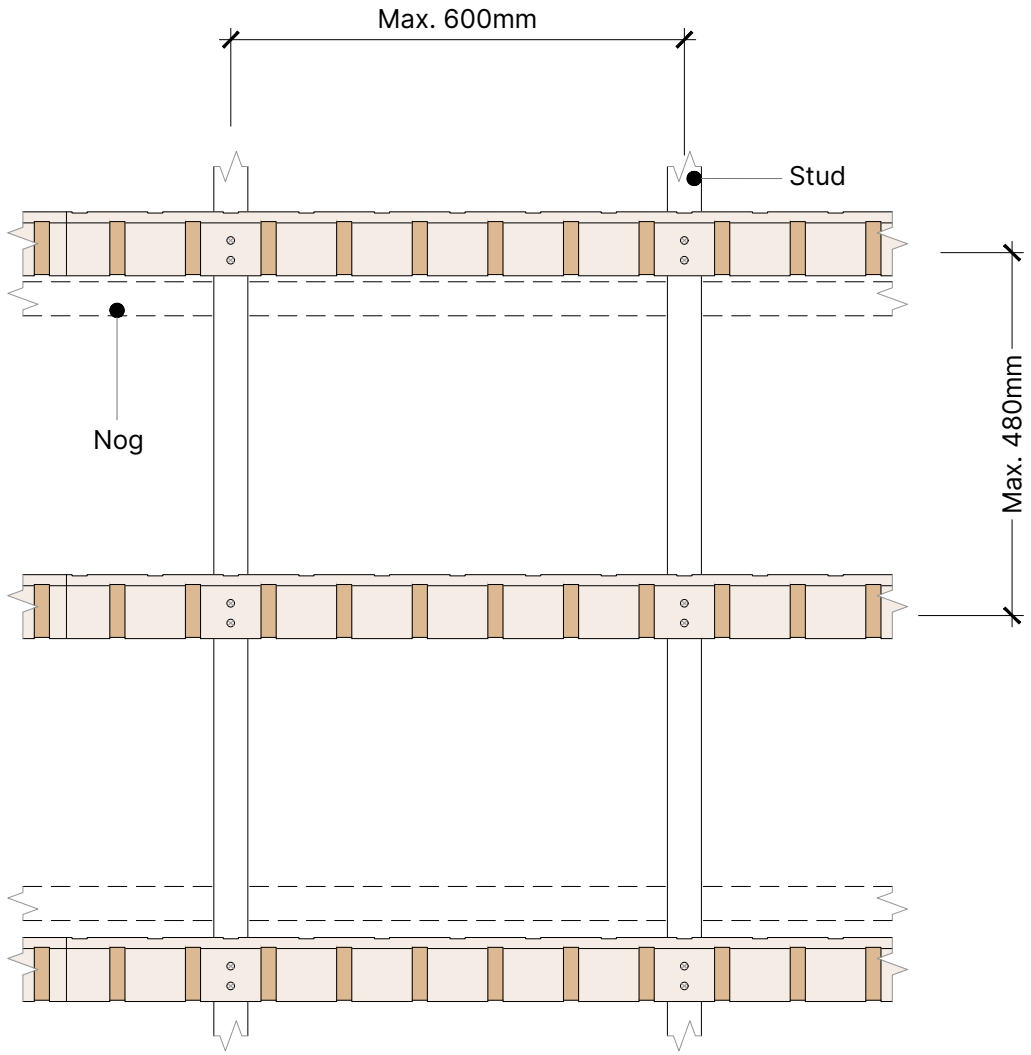

Studs @ 600mm | CB @ 480mm max.

In this scenario Cavity Battens are not required to be supported by a nog

JSC 45mm Cavity Battens can be fixed to structures outside of NZS 3604:2011 timber framing. Cavity Batten fixings should be determined by engineer based on fixing tensions required on tables below:

	Max. Stud Spacing	Max. Nog Spacing	Max. Cavity Batten Spacing	Wind Zones	Fixing Tension Required (kN/m)	Cavity Batten Suitable *Fixing	Cavity Batten Fixing Span
H1	400mm	Cavity Batten not required to be supported by a nog	480mm	up to Very High	0.5	1 OR 2	400mm over the studs
				Extra High	0.6	1 OR 2	
H2	600mm	800mm Alternating nogs behind every second Cavity Batten	400mm	up to Very High	0.7	1 OR 2	300mm when nog behind and 600mm when no nog behind
				Extra High	0.9	2	
H3	600mm	Cavity Batten not required to be supported by a nog	480mm	up to Very High	0.7	1 OR 2	600mm over the studs
				Extra High	0.9	2**	

*Refer to Fixings

VERTICAL CAVITY BATTENS/ HORIZONTAL WEATHERBOARDS

V1 SCENARIO
JSC-V 45x45mm CAVITY BATTEN

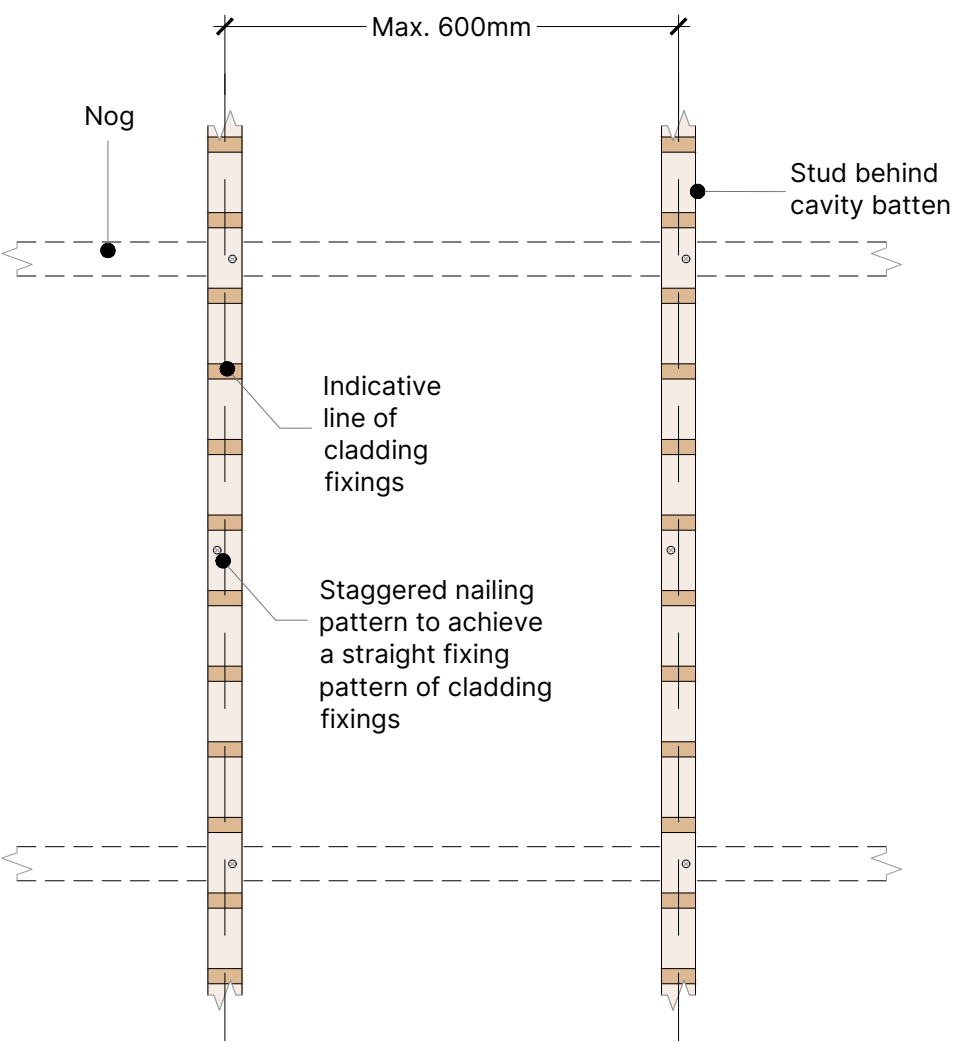

Studs @ 600mm | CB @ 600mm max.

Nogs as per NZS 3604:2011 or SED design

V2 SCENARIO
JSC-V 45x45mm CAVITY BATTEN

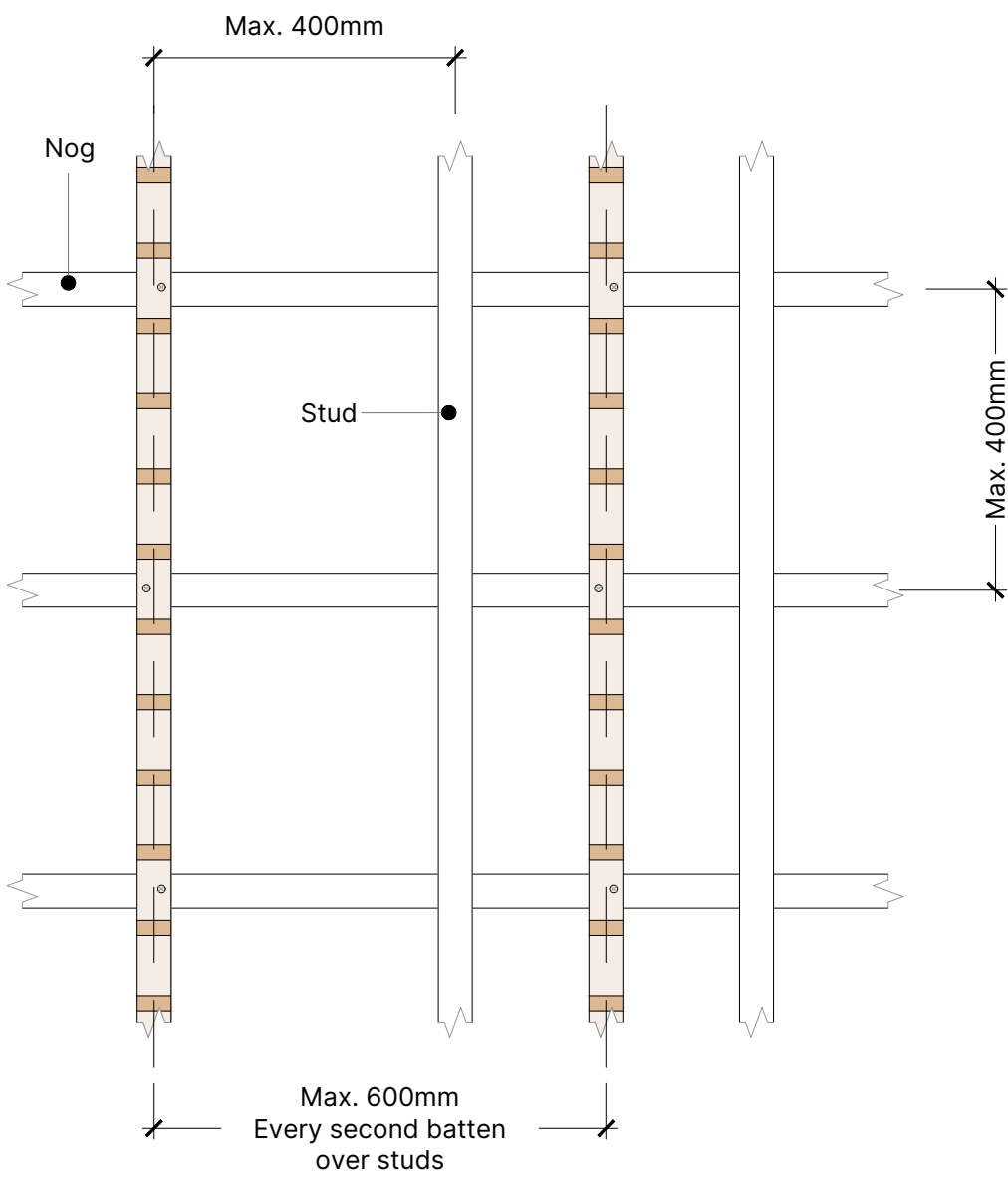

Studs @ 400mm | CB @ 600mm max. | Nogs @400mm

Every second Cavity Batten fixed over a stud

V3 SCENARIO
JSC 70x45mm CAVITY BATTEN

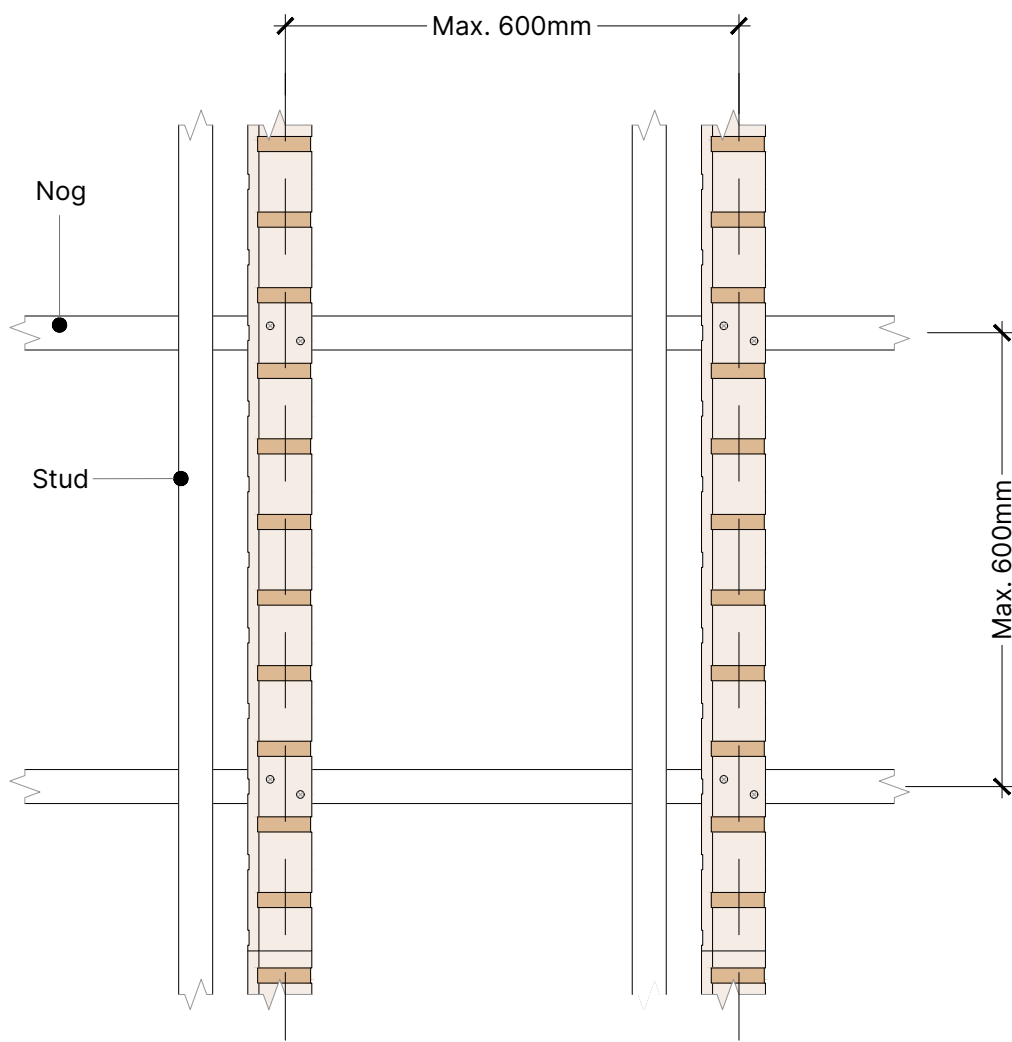

Studs as per NZS 3604:2011 or SED design | CB @ 600mm max. | Nogs @600mm max.

	Max. Stud Spacing	Max. Nog Spacing	Max. Cavity Batten Spacing	Wind Zones	Fixing Tension Required (kN/m)	Cavity Batten *Fixing Span	
						Fixing 1	Fixing 2
V1	600mm	No specific requirement for nogs	600mm	up to Very High	1.8	400mm	600mm
				Extra High	2.2	300mm	500mm
V2	400mm	400mm	600mm Every second batten over studs	up to Very High	1.8	400mm	600mm
				Extra High	2.2	N/A	400mm
V3	As per NZS 3604:2011	600mm	600mm	up to Very High	0.7	600mm	600mm
				Extra High	0.9	N/A	600mm**

*Refer to Fixings

FIXINGS:			
1.	1/ 90mm x 3.15mm Stainless Steel Annular grooved gun nail	2.	1/ 90mm x 10g Stainless Steel Wood screw
			**2/ 90mm x 3.15mm Stainless Steel Annular grooved gun nail

NOTES

- Cavity battens are profiled to JSC Specifications and are treated to H3.2 CCA as per NZS 3604:2011
- Wall Underlay and other building components are not shown to provide more clarity
- Rigid wall underlay to be fibre cement or plywood. Low density boards to be addressed appropriately
- Details may be subject to change without notice
- Framing must be as per NZS 3604:2011 or fit for purpose and other building elements may need to be accommodated
- JSC structural cavity battens have not been evaluated for installation with other cladding types. The structural cavity battens are designed as an addition to the structural frame and their only function is to support JSC timber weatherboards.

- Custom setup options may be available. Contact us to discuss your design requirements
- To be read in conjunction with complete JSC Cladding System literature. Visit www.jsc.co.nz