

SEQUENCE :

1. Framing
2. Wall Underlay
3. Parapet Cavity battens
4. Packer to form slope
5. Flexible Flashing tape

DETAIL NOTE :

REFER TO E2/AS1 FIGURE 12 FOR SADDLE FLASHING DIMENSIONS

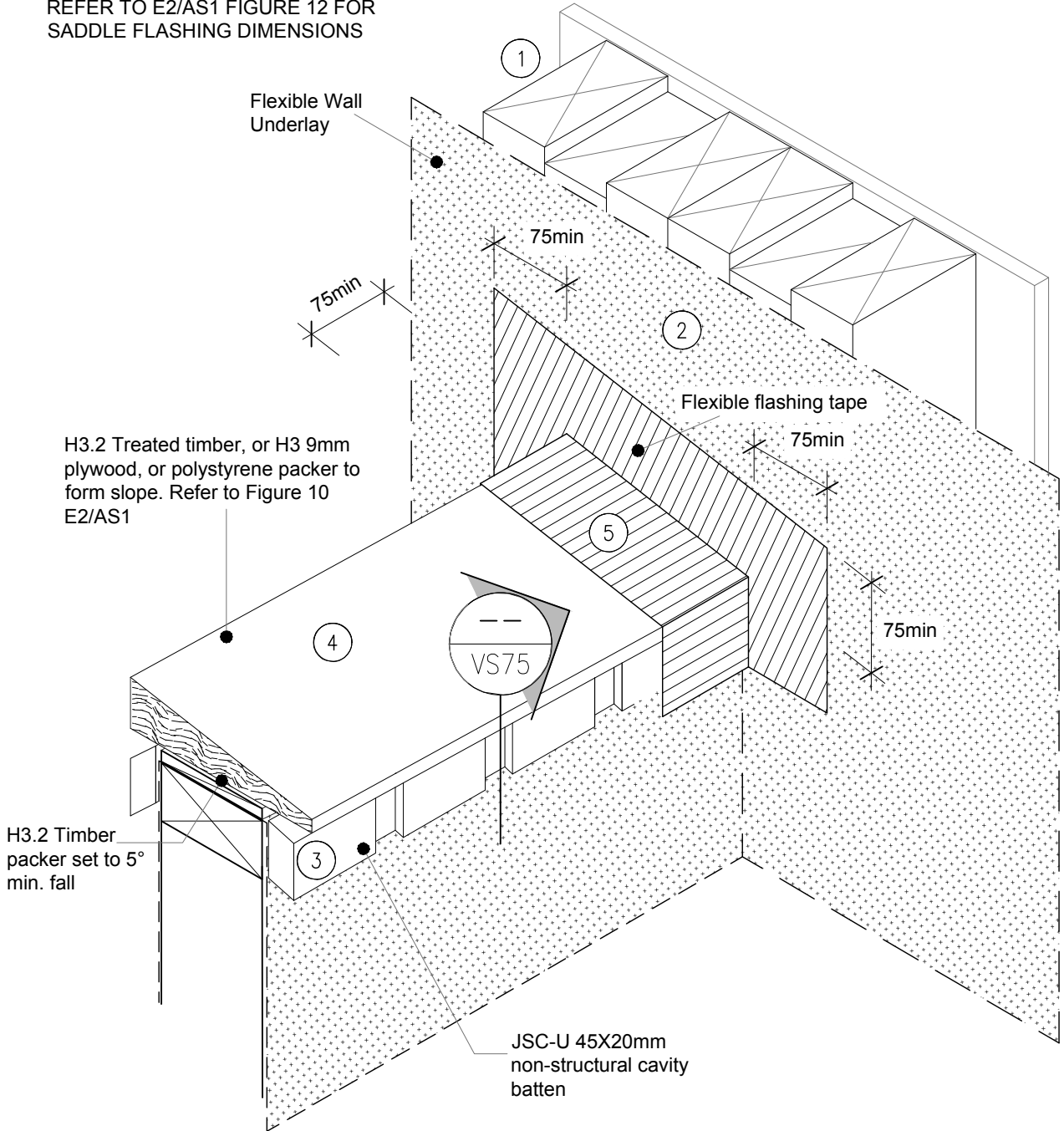

• TO BE READ IN CONJUNCTION WITH COMPLETE JSC VERTICLAD SYSTEM LITERATURE

CodeMark
CMNZ30062



to be updated

SEQUENCE :

1. Framing
2. Wall Underlay
3. Parapet Cavity battens
4. Packer to form slope
5. Flexible Flashing tape
6. Cavity battens on wall
7. Corner flashings

DETAIL NOTE :

REFER TO E2/AS1 FIGURE 12 FOR SADDLE FLASHING DIMENSIONS

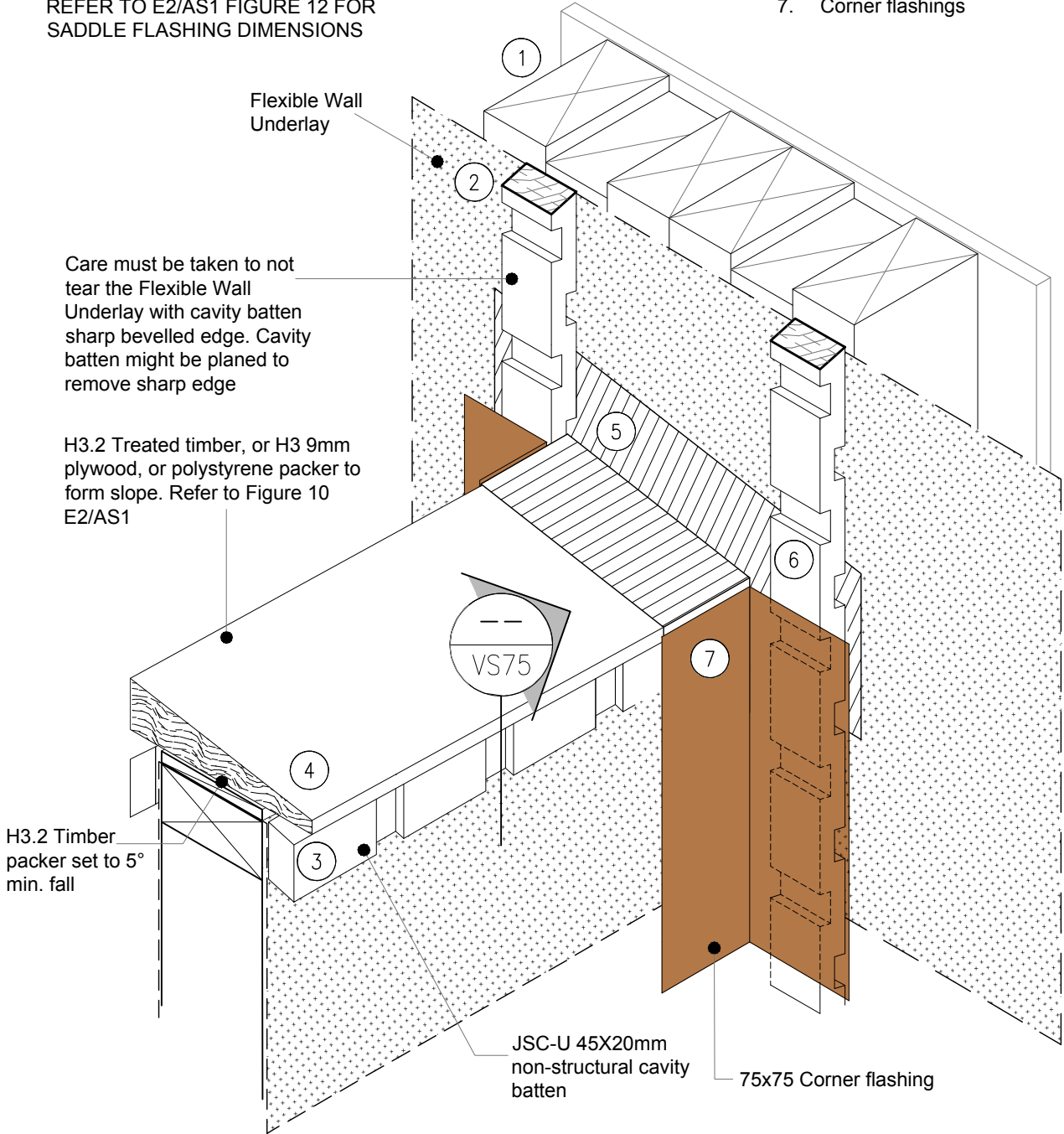

• TO BE READ IN CONJUNCTION WITH COMPLETE JSC VERTICLAD SYSTEM LITERATURE

CodeMark
CMNZ30062



DRAWING SCALE NTS	ISSUE DATE 16/01/2025
DRAWING NUMBER JSC 20CF VS72	VERSION 2.5

to be updated

DETAIL NOTE :

REFER TO E2/AS1 FIGURE 12 FOR SADDLE FLASHING DIMENSIONS

SEQUENCE :

- 8. Cladding
- 9. Separation layer
- 10. Saddle Flashing

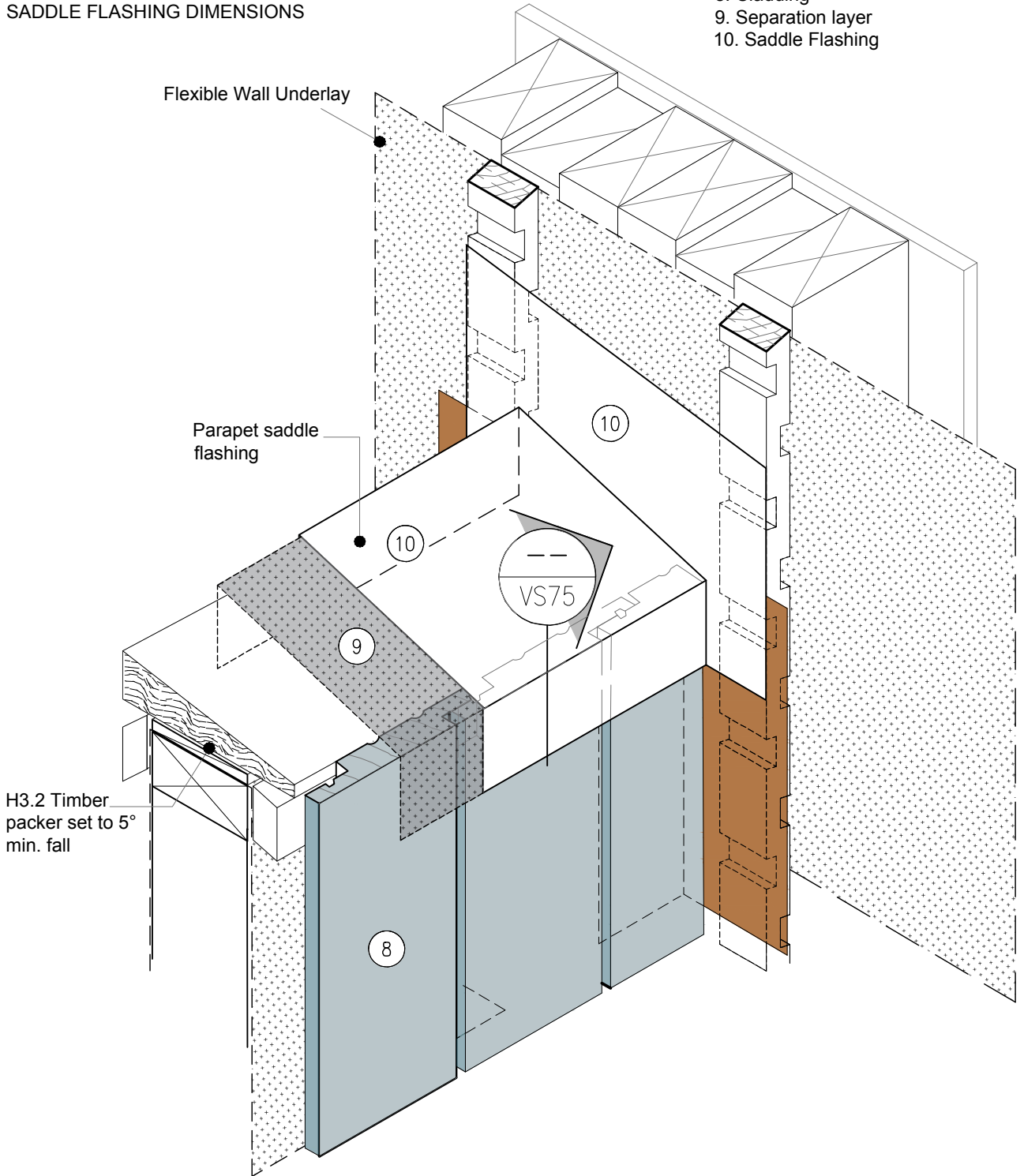

• TO BE READ IN CONJUNCTION WITH COMPLETE JSC VERTICLAD SYSTEM LITERATURE

CodeMark
CMNZ30062



jsc.co.nz
TechHelp@jsc.co.nz | (09) 412 2812

TYPE
VERTICAL SHIPLAP WB - 20MM CAVITY FIX

NAME
Parapet Saddle Flashing - STAGE THREE

• DETAILS MAY BE SUBJECT TO CHANGE WITHOUT NOTICE



SCAN IT FOR MORE INFORMATION

DRAWING SCALE NTS	ISSUE DATE 16/01/2025
DRAWING NUMBER JSC 20CF VS73	VERSION 2.5

to be updated

DETAIL NOTE :

REFER TO E2/AS1 FIGURE 12 FOR
SADDLE FLASHING DIMENSIONS

SEQUENCE :

- 11. Cladding over saddle flashing
- 12. Cap flashing

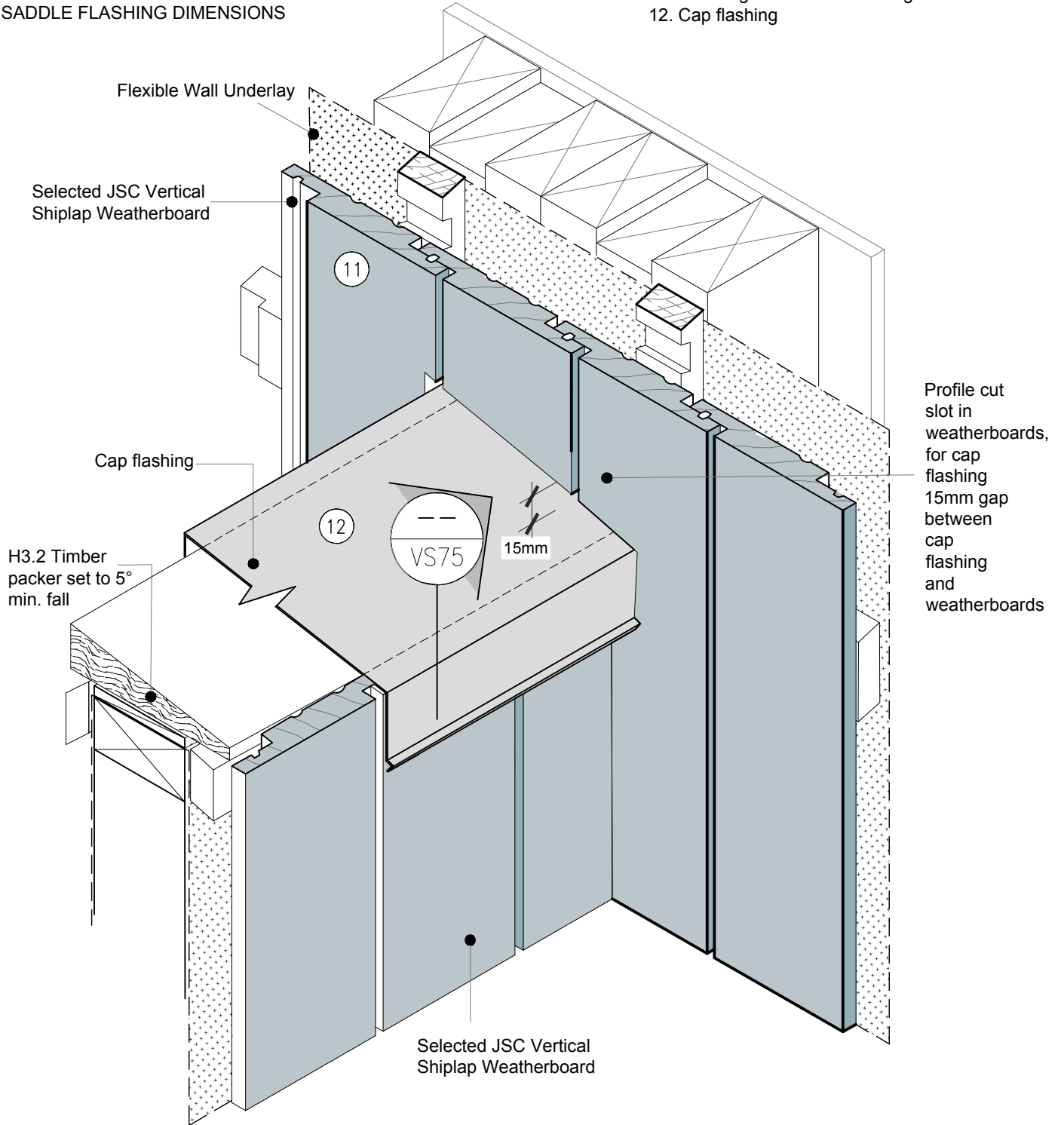

• TO BE READ IN CONJUNCTION WITH COMPLETE JSC VERTICLAD SYSTEM LITERATURE

CodeMark
CMNZ30062



jsc.co.nz
TechHelp@jsc.co.nz | (09) 412 2812

TYPE
VERTICAL SHIPLAP WB - 20MM CAVITY FIX
NAME
Parapet Saddle Flashing - STAGE FOUR

• DETAILS MAY BE SUBJECT TO CHANGE WITHOUT NOTICE



SCAN IT FOR MORE
INFORMATION

DRAWING SCALE 1:2 @ A4	ISSUE DATE 15/01/2025
DRAWING NUMBER JSC 20CF VS74	VERSION 2.5

to be updated